

# KAWASAKI ZX-10R/RR '16-

## M O U N T I N G I N S T R U C T I O N S

REF 20704

SEAT COWL



**THE SAME INSTALLATION AS ORIGINAL PASSENGER'S SEAT**

ID.	PIEZA/PART	DESCRIPCIÓN	DESCRIPTION	QTY.	REF.:
1		Colin (ABS)	Rear seat cowls (ABS)	1	20704N/J/CM3
2		Soporte inferior aluminio	Lower aluminum support	1	SOPOR3P9-I20704
3		Soporte superior aluminio ( Verde )	Upper aluminum support ( Green )	1	SOPOR3P9-S20704
4		Tomillo allen M5x12 Ø11 ISO 7380	M5x12 Ø11 ISO 7380 allen screws	2	TORNI-AI----520
5		Arandela de goma Ø4,5 x Ø11 x 2mm	Ø4,5 x Ø11 x 2mm rubber washer	4	ARAND-EPDM--722
6		Tornillo M5x12 DIN7991	M5x12 DIN7991 screw	4	TORNI-D7991-611
7		Tapón tornillo M5 DIN7991	M5 DIN7991 screw cap	2	TAPON-----92
8		Tope de goma Ø3,7-3,8 x 3,2mm	Ø3,7-3,8 x 3,2mm rubber stop	4	TOPE--POF-40022
9		Adhesivo de Resina ( No se suministra montado )	Resin Adhesive ( Not supplied assembled )	1	ADHESI----20704
10		Espuma ( No se suministra montado )	Foam ( Not supplied assembled )	1	ESPUMA----20704

# KAWASAKI ZX-10R/RR '16-

INSTRUCCIONES DE MONTAJE - MOUNTING INSTRUCTIONS - MONTAGEANLEITUNG

## OPTION A: WITH UPPER SUPPORT

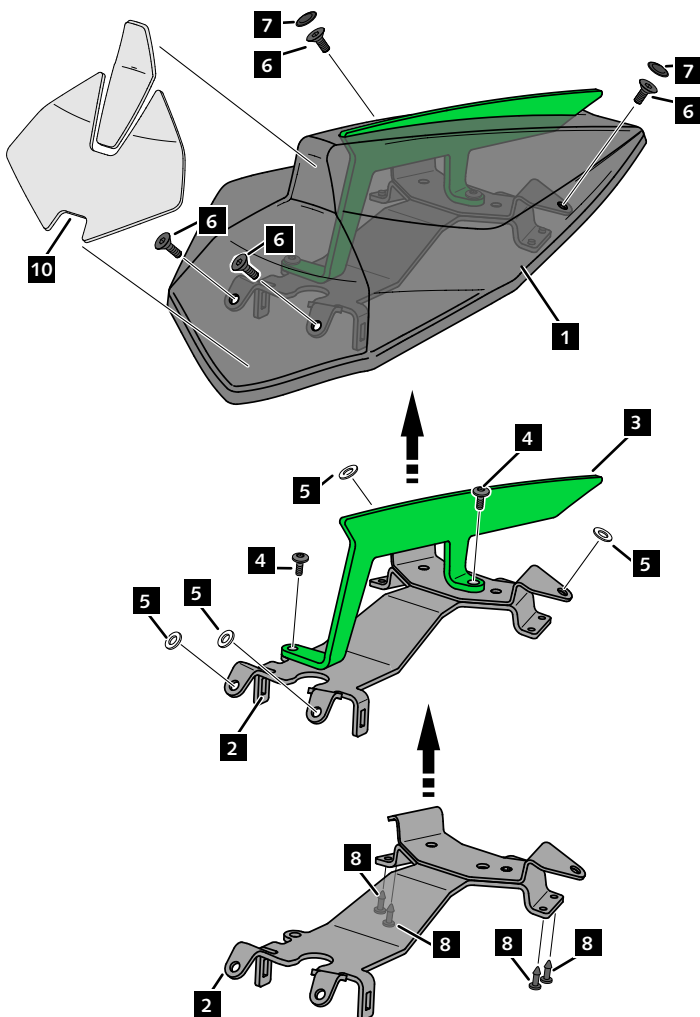
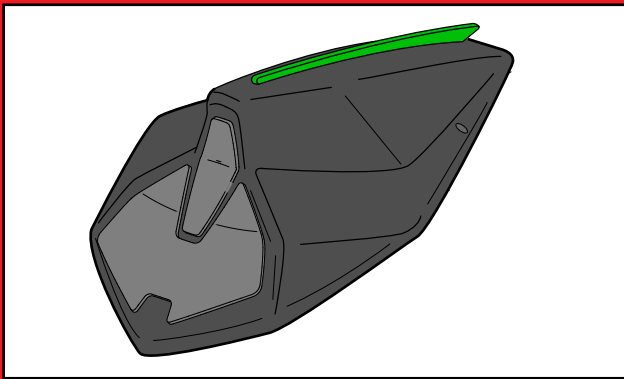

## OPTION B: WITHOUT UPPER SUPPORT

