

YAMAHA YZF R1 '15-

M O U N T I N G I N S T R U C T I O N S

REF 20127N

TAPA ALTERNADOR / ALTERNATOR COVER



1 Person



1 hour



EASY

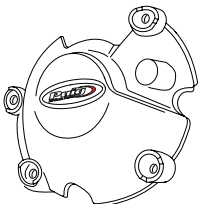
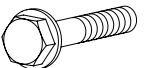

ID.	PIEZA / PART	DESCRIPCIÓN	DESCRIPTION	QTY.	REF.:
1		Tapa alternador	Alternator cover	1	CONJUNTO--20127N
2		Tornillo M6x35 DIN6921	DIN6921 M6x35 screw	4	-

**CONSULTAR EN NUESTRA PAGINA WEB LA DISPONIBILIDAD DEL VIDEO DE MONTAJE DE ESTA REFERENCIA.
CONSULT OUR WEBSITE THE VIDEO MOUNT AVAILABILITY OF THIS REFERENCE.**



YAMAHA YZF R1 '15-

REF 20127N

INSTRUCCIONES DE MONTAJE - MOUNTING INSTRUCTIONS - MONTAGEANLEITUNG

1

DISASSEMBLY
DESMONTAJE

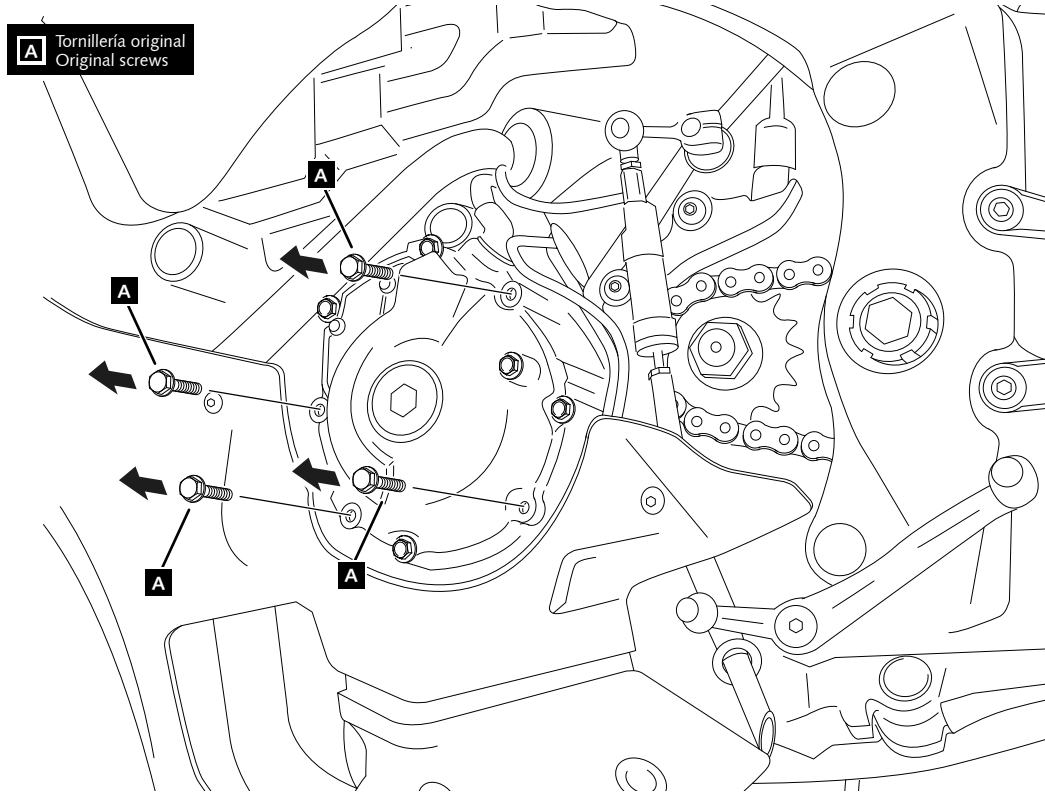

2

ASSEMBLY
MONTAJE

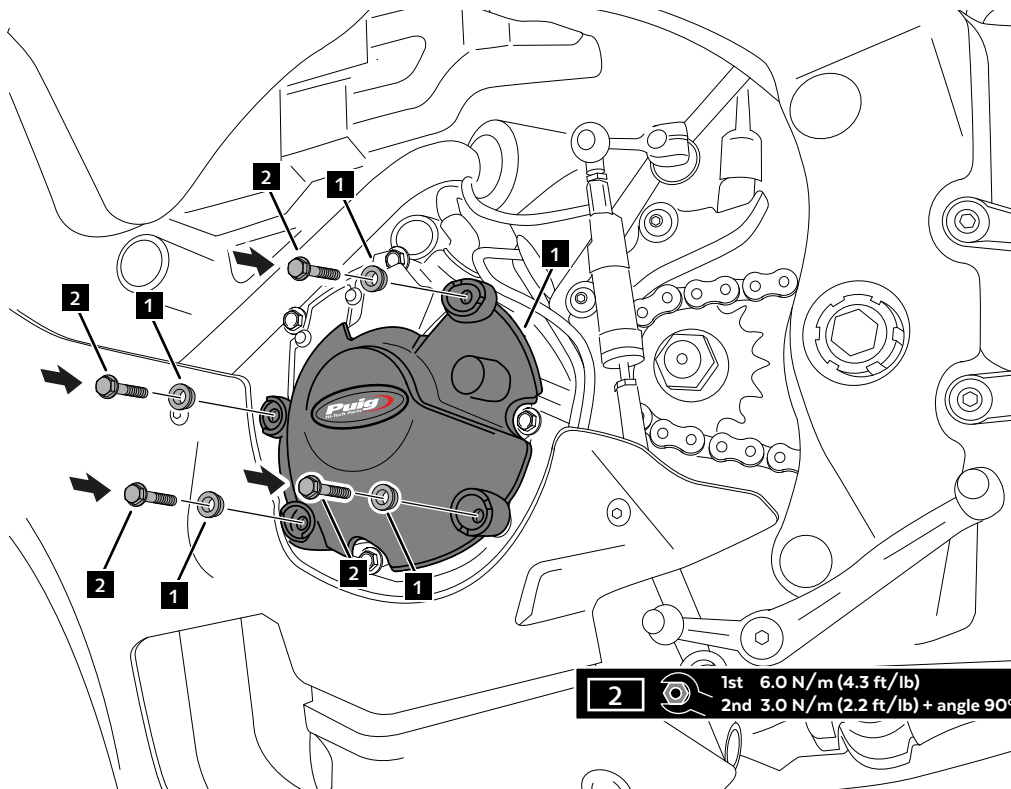

2 1st 6.0 N/m (4.3 ft/lb)
2nd 3.0 N/m (2.2 ft/lb) + angle 90° "Par de apriete"
"Torque"

YAMAHA YZF R1 '15-

M O U N T I N G I N S T R U C T I O N S

REF 20127N

TAPA EMGRAGUE / TAPA BOMBA AGUA
CLUTCH COVER / WATER PUMP COVER



1 Person



1 hour



EASY

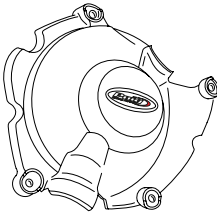
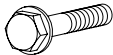
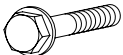
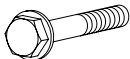

ID.	PIEZA / PART	DESCRIPCIÓN	DESCRIPTION	QTY.	REF:
1		Tapa bomba de agua	Water pump cover	1	CONJUNTO--20127N
2		Tapa embrague	Clutch cover	1	CONJUNTO--20127N
3		Tornillo M6x35 DIN6921	M6x35 DIN6921 screw	4	-
4		Tornillo M6x45 DIN6921	M6x45 DIN6921 screw	2	-
5		Tornillo M6x50 DIN6921	M6x50 DIN6921 screw	2	-

YAMAHA YZF R1 '15-

REF 20127N

INSTRUCCIONES DE MONTAJE - MOUNTING INSTRUCTIONS - MONTAGEANLEITUNG

1

DISASSEMBLY
DESMONTAJE

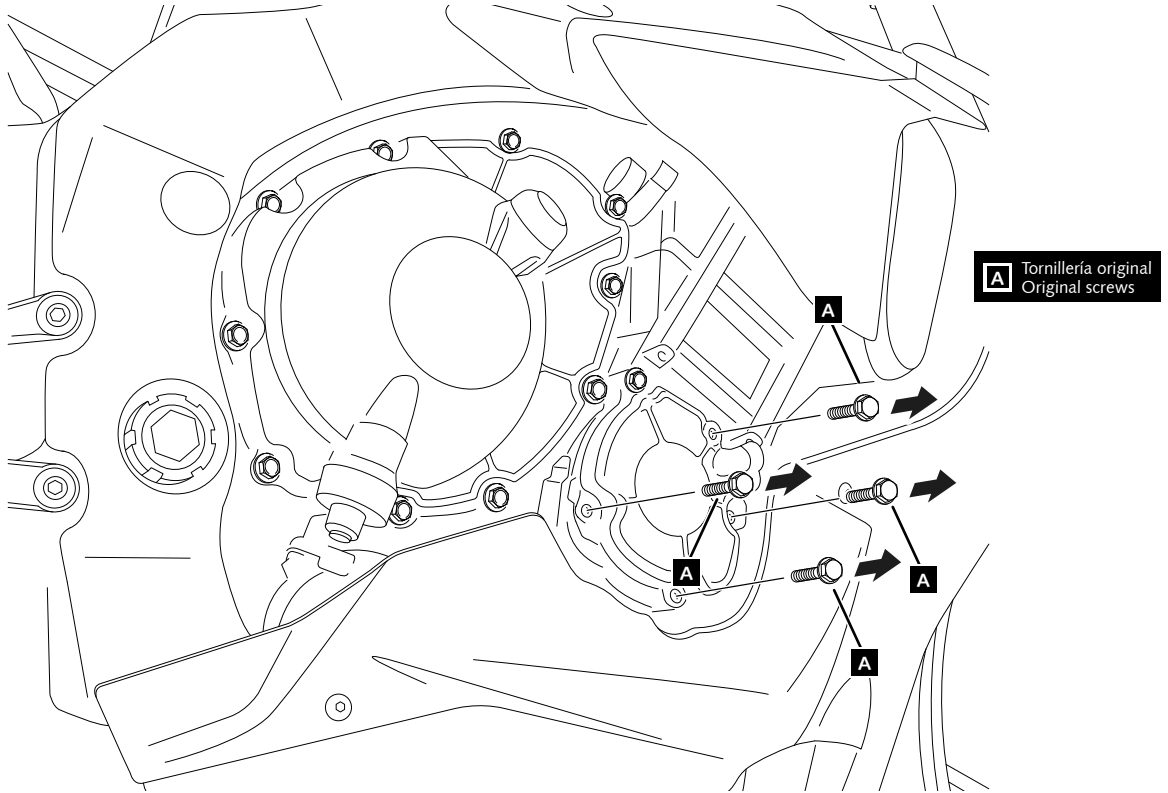

2

ASSEMBLY
MONTAJE

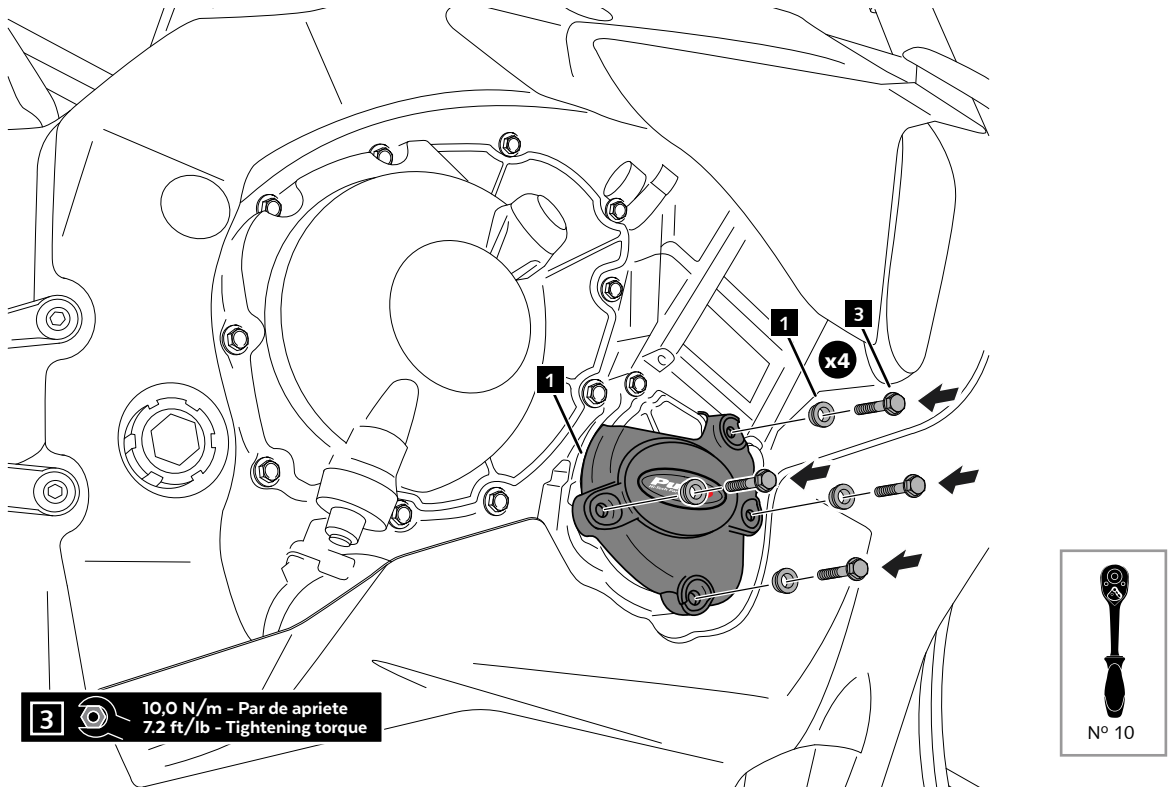

YAMAHA YZF R1 '15-

REF 20127N

INSTRUCCIONES DE MONTAJE - MOUNTING INSTRUCTIONS - MONTAGEANLEITUNG

3

DISASSEMBLY
DESMONTAJE

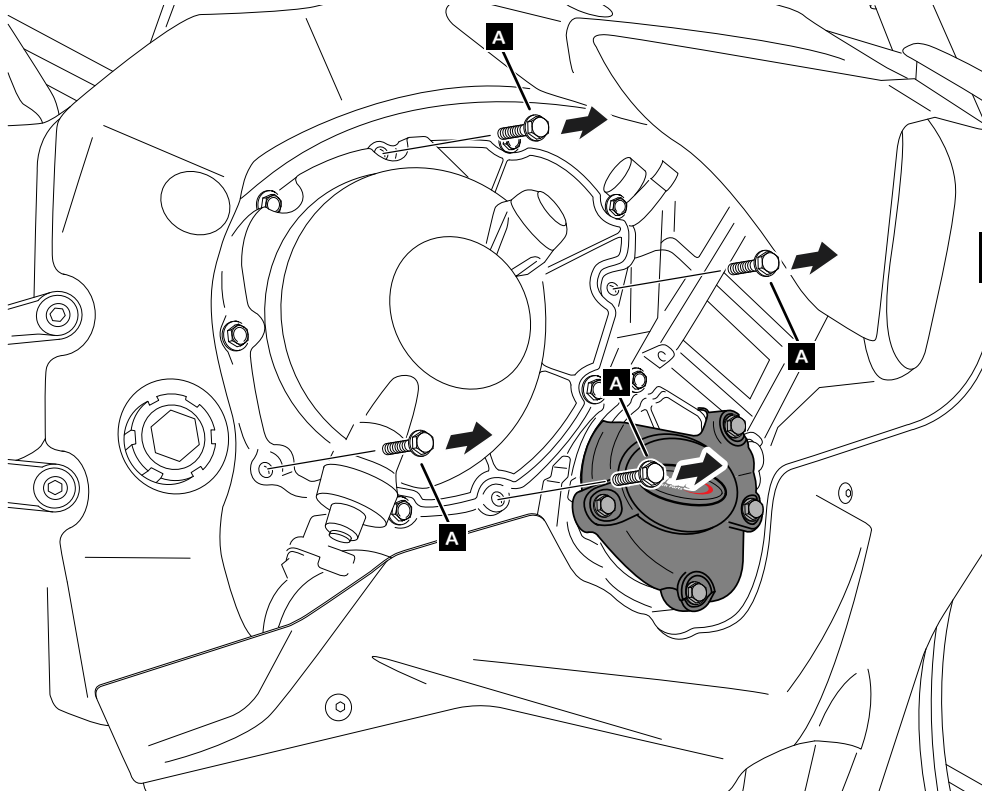

A Tornillería original
Original screws

4

ASSEMBLY
MONTAJE

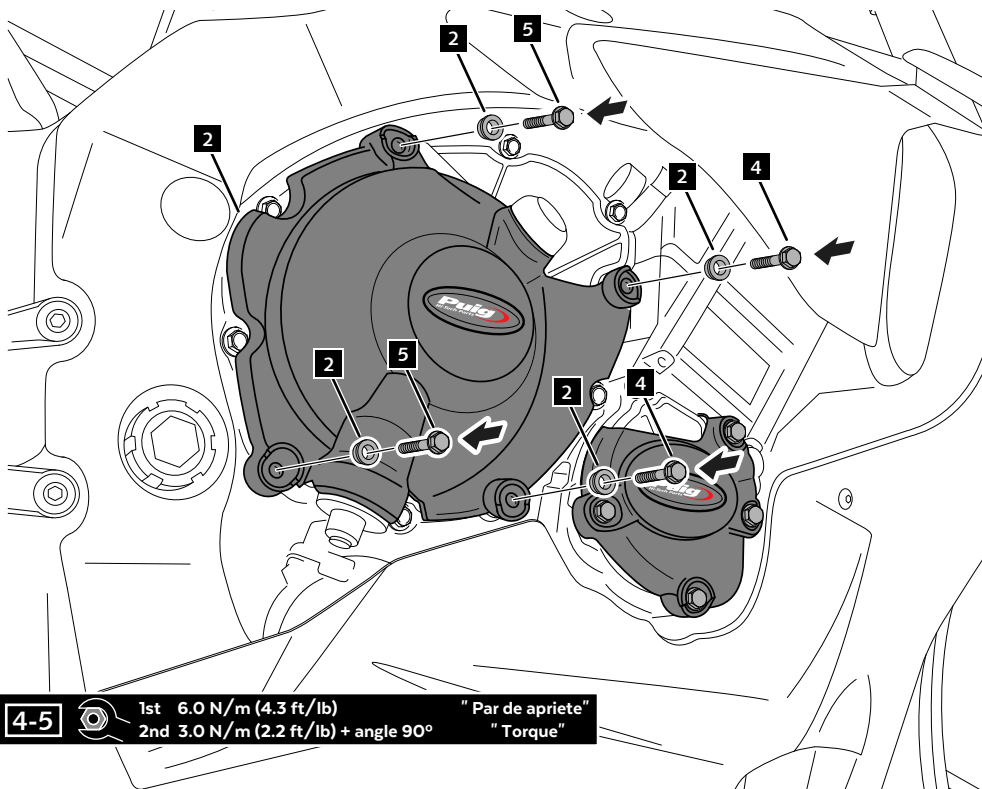

4-5 1st 6.0 N/m (4.3 ft/lb) "Par de apriete"
2nd 3.0 N/m (2.2 ft/lb) + angle 90° "Torque"

